

L 185/2

Busbar supports made of duroplast

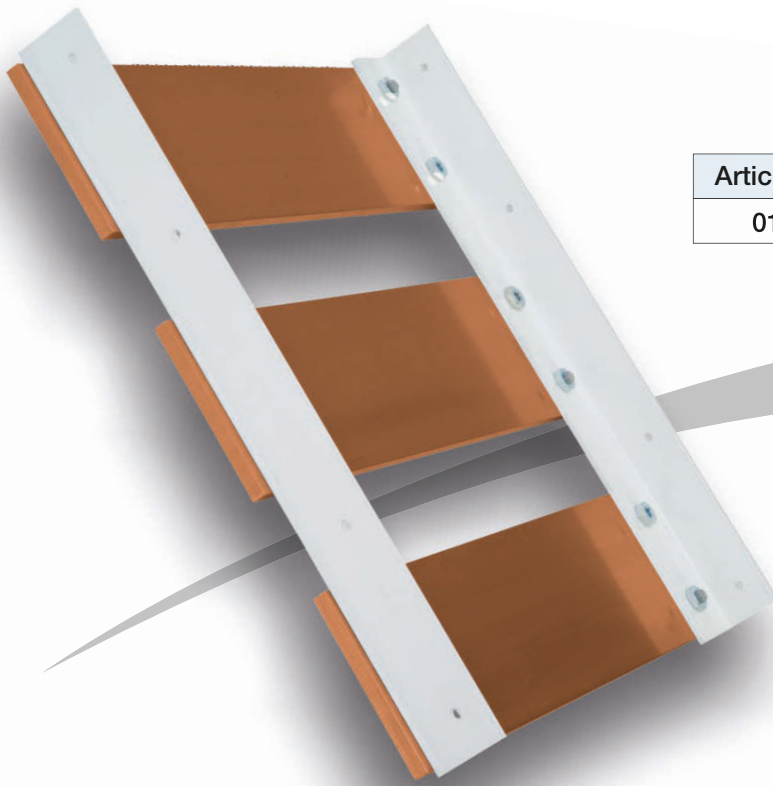

Article number	Colour
011305	Grey

- Operational alternating current 1000 Volt
- Continuous current exceeding 4000 A
- Phase interval 185 mm

Short-circuit resistance of L185/2

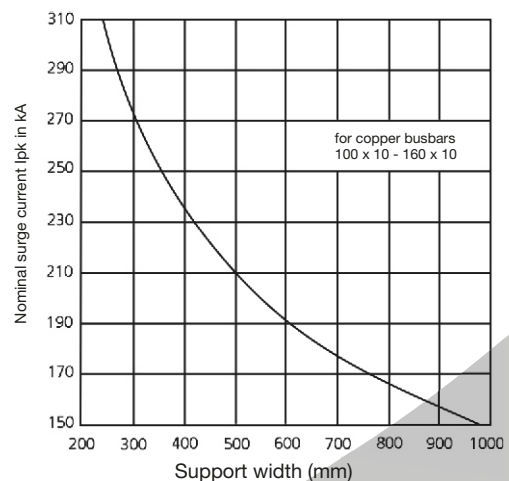

Raw material properties

Thermal dimensional stability acc. to Martens	DIN 53462	°C	>150
Gross density	ISO 1183	g/cm ³	1,75
Fire behavior	UL 94	class	HB
Special volume resistivity	IEC 60093	Ohm cm	10 ¹²
Dielectric strength (90 °C (vertical)	IEC 60243	kV/3 mm	38
Creep resistance	IEC 60112	CTI	600
Halogens	none (Beilstein's test)		

(additional data available on request)

The data given are subject to certain tolerances affected by manufacturing processes as well as the inserted pre-products. That is why these figures are average values, i.e. non-binding standard values which cannot be used to derive a guarantee claim from. We reserve the right to make changes!

L 185/2

Busbar supports made of duroplast

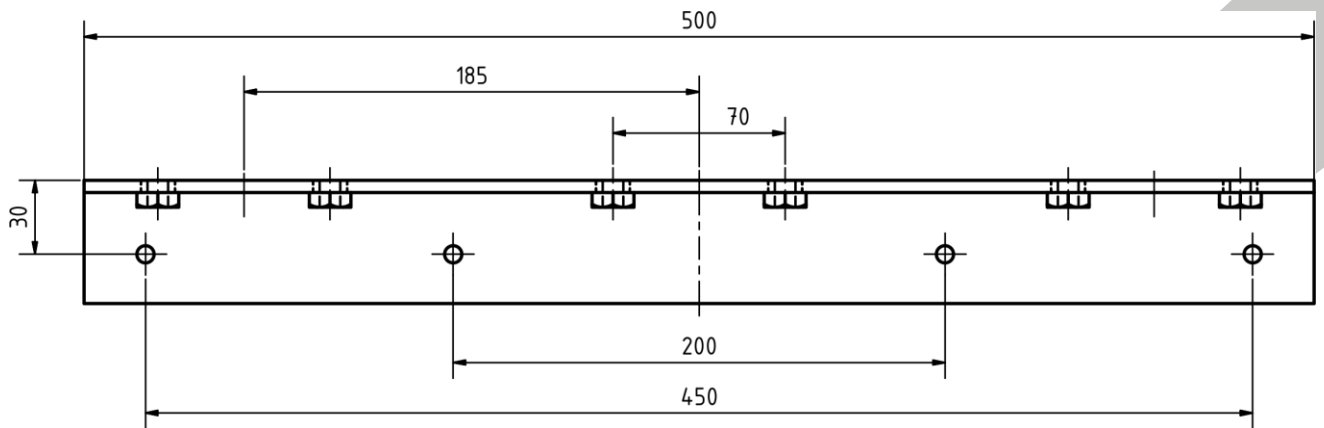
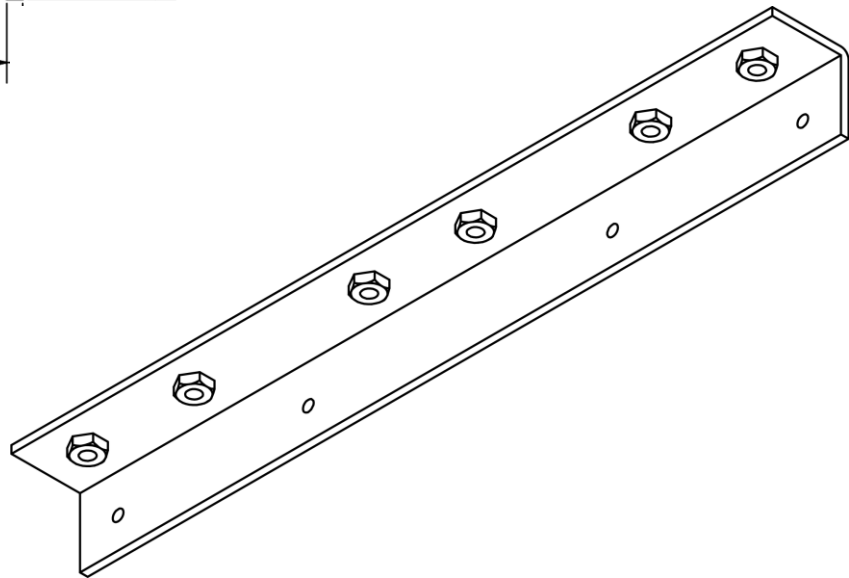
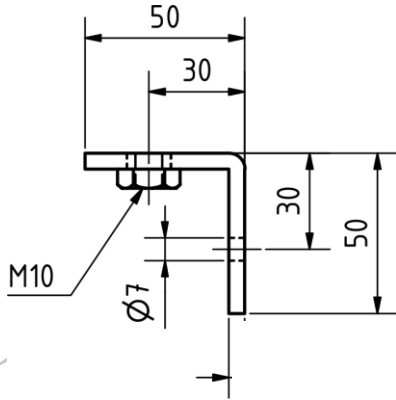

The data given are subject to certain tolerances affected by manufacturing processes as well as the inserted pre-products. That is why these figures are average values, i.e. non-binding standard values which cannot be used to derive a guarantee claim from. We reserve the right to make changes!